

**BEAUFORT COUNTY  
HISTORIC SITES SURVEY - 1997**

**INTENSIVE LEVEL BUILDING INVENTORY FORM**

Statewide Survey Site Form  
State Historic Preservation Office  
South Carolina Department of Archives and History  
Columbia, SC

Site Number: U- 13 - 1392  
Access County Site #  
USGS Quad: 025 Beaufort  
Doc. Level: Intensive Level-Building

Historic name(s): \_\_\_\_\_ Map Ref.: Topo Quad Tax Number: R10000900A01720000  
Common name(s): \_\_\_\_\_ City Block Ref.: \_\_\_\_\_ Island: Lady's Is.  
Address/location: 6 Sussex Ct. City/Vicinity of (vic.) Beaufort vic.  
Date: 1850 ca. Alteration date: ca. 1957; ca. 1970  
Ownership:  1. private  2. city  3. county  4. state  5. federal  6. unknown  
Category:  1. building  2. site  3. structure  4. object  
Historic use(s): single dwelling Current uses: single dwelling

National Register Status: \_\_\_\_\_ Date: \_\_\_\_\_ Listing Name: \_\_\_\_\_ NRIS # \_\_\_\_\_

SHPO National Register Evaluation: \_\_\_\_\_ Name: \_\_\_\_\_

Consultant Recommendation: Contributes to potential local district Name: Pleasant Point Plantation

Previous Survey: \_\_\_\_\_ Reference: \_\_\_\_\_ Notes: \_\_\_\_\_  
 H.A.B.S.  Other \_\_\_\_\_  
 Feiss-Wright (1969) \_\_\_\_\_  
 Historic Resources of the Lowcountry (1979) \_\_\_\_\_  
 Milner Historic District Inventory (1979) \_\_\_\_\_  
 A Guide to Historic Beaufort (1995 ed.) \_\_\_\_\_

Photograph: \_\_\_\_\_



Photographs:

- prints
- slides
- negatives

Date: 3/9/98

Recorder: D. Schneider, Historic Beaufort Fdn.

Roll # Neg. View of:  
S-17 03 S facade & W elev., fac. NE

Style: \_\_\_\_\_ Commercial Form: \_\_\_\_\_

Core Shape: rectangular \_\_\_\_\_ Stories: 1 story \_\_\_\_\_ Construction: frame \_\_\_\_\_  
 Roof: Shape: hip \_\_\_\_\_ Material: composition shingle \_\_\_\_\_

Chimney: Type: interior \_\_\_\_\_ Material: brick \_\_\_\_\_

Exterior Walls: weatherboard \_\_\_\_\_

Windows: single \_\_\_\_\_ Type: double hung \_\_\_\_\_ Pane 9/9 \_\_\_\_\_  
 modern picture \_\_\_\_\_ Config.: \_\_\_\_\_

Doors: single \_\_\_\_\_ Foundation: brick piers \_\_\_\_\_  
 french \_\_\_\_\_

Porch Height: 1 story \_\_\_\_\_ Porch Width: full facade \_\_\_\_\_ Porch Roof Shape: hip \_\_\_\_\_  
 Porch Details: chamfered posts \_\_\_\_\_ Decorative \_\_\_\_\_  
 other balustrade \_\_\_\_\_ Elements: \_\_\_\_\_

Outbuildings: none \_\_\_\_\_ Interior \_\_\_\_\_  
 Features: \_\_\_\_\_

Number of Related Resources: \_\_\_\_\_

Surroundings: residential \_\_\_\_\_ Acreage: \_\_\_\_\_ Quadrangle: Beaufort \_\_\_\_\_

Alterations: Alteration date: ca. 1957; ca. 1970 Integrity: fair Condition: good  
 House was rehabilitated ca. 1957: porch was partially enclosed, possible residing, chimneys rebuilt, interior plan modified & ceiling joists exposed; the rear wing and enclosed roof at ground level added after 1970

Description: Rectangular 7 x 3 bay frame dwelling on high brick pier foundation. Bellcast hipped composition shingle roof with 2 interior chimneys. Full-facade hipped porch; now enclosed @ E end. Former 1-bay deep shed extension and modern T wing w/hipped roof at rear w/stoop and deck. Former cornerboard at E elev. suggests front porch originally wrapped to that elevation.

Historical Data: Reportedly built in the 1850s. The property was owned in the 20th century by B. S. Merritt, Sr., who operated the plantation as a Hereford cattle breeding farm. In recent years, the plantation has been subdivided as a residential and golf community. Cuthbert family associated w/property on Mills' Atlas of 1825.

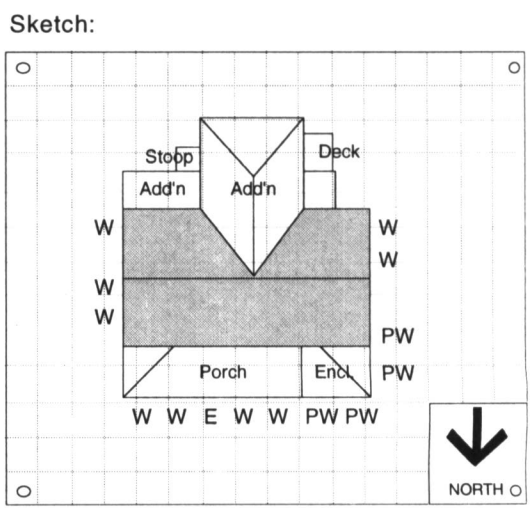

Site Number: U - 13 - 1392

Informant/ Bibliography: Historic Beaufort Foundation historic sites survey files; interview with Mrs. R. Tompkins, 6 Sussex Ct.