

**BEAUFORT COUNTY  
HISTORIC SITES SURVEY - 1997**

INTENSIVE LEVEL BUILDING INVENTORY FORM

Statewide Survey Site Form  
State Historic Preservation Office  
South Carolina Department of Archives and History  
Columbia, SC

Site Number: U- 13 - 515  
Access County Site #  
USGS Quad: 025 Beaufort  
Doc. Level: Intensive Level-Building

Historic name(s): Scheper, F. W., House Map Ref.: PR 12 Tax Number: R110 011 000 060A 0000  
Common name(s): \_\_\_\_\_ City Block Ref.: \_\_\_\_\_ Island: Port Royal Is.  
Address/location: 904 8th St. City/Vicinity of (vic.) Port Royal  
Date: 1885 ca. Alteration date: 1930 ca.; 1970 ca.  
Ownership:  1. private  2. city  3. county  4. state  5. federal  6. unknown  
Category:  1. building  2. site  3. structure  4. object  
Historic use(s): single dwelling Current uses: single dwelling

National Register Status: \_\_\_\_\_ Date: \_\_\_\_\_ Listing Name: \_\_\_\_\_ NRIS # \_\_\_\_\_

SHPO National Register Evaluation: \_\_\_\_\_ Name: \_\_\_\_\_

Consultant Recommendation: Contributes to potential local district Name: Port Royal Historic District

Previous Survey: \_\_\_\_\_ Reference: \_\_\_\_\_ Notes: \_\_\_\_\_  
 H.A.B.S.  Other \_\_\_\_\_  
 Feiss-Wright (1969) \_\_\_\_\_  
 Historic Resources of the Lowcountry (1979) \_\_\_\_\_  
 Milner Historic District Inventory (1979) \_\_\_\_\_  
 A Guide to Historic Beaufort (1995 ed.) \_\_\_\_\_

Photograph:



Photographs:

- prints
- slides
- negatives

Date: 7/1/97

Recorder: D. Schneider, Historic Beaufort Fdn.

Roll # Neg. View of:  
B-08 14 S facade & W elev., fac. NE



Style: \_\_\_\_\_ Commercial Form: \_\_\_\_\_

Core Shape: irregular Stories: 1 story Construction: frame  
Roof: Shape: cross gable Material: composition shingle

Chimney: Type: interior Material: brick

Exterior Walls: synthetic siding

Windows: single Type: double hung Pane 6/6  
Config.: \_\_\_\_\_

Doors: single Foundation: brick

Porch Height: 1 story Porch Width: facade & right elevation Porch Roof Shape: shed  
Porch Details: supports on pedestals Decorative Elements: slat balusters

Outbuildings: none Interior Features: \_\_\_\_\_

Number of Related Resources: \_\_\_\_\_

Surroundings: residential Acreage: \_\_\_\_\_ Quadrangle: Beaufort

Alterations: Alteration date: 1930 ca.; 1970 ca. Integrity: fair Condition: good  
Replacement porch (1930 ca.); synthetic siding, porch infill (1970 ca.)

Description: Irregularly shaped 1 story frame dwelling w/cross gable roof. 1-story porch across facade & E elev., now infilled at facade.

Historical Data: The house appears on the 1905, 1913 and 1924 Sanborn maps. According to the Christensen Notes listed below, F. W. Scheper purchased lots #1-3 of block 52 by 1882. The assessor's office indicates the house was built in 1930. This latter date may suggest an extensive remodeling about that time, possibly just prior to or after the acquisition of the additional lots #5 & #6 by Scheper in 1934.

Christensen Notes refer to the site as "Scheper/Port House" and list the following chain of title: Daniel F. Appleton to F. W. Scheper (lot #1), 4/1/1872; D.F.A. to F. W. Scheper (lot #2 & 3), 10/30/1882; D.F.A. to F. W. Scheper (lot #4), 12/26/1916; Port Royal Land Co. to F. W. Scheper (lots #5-6), 2/16/1934; F. W. Scheper to A. F. Queens, 1958; A. F. Queens to Russell Ports?, no date cited [this information not verified].

Sketch:

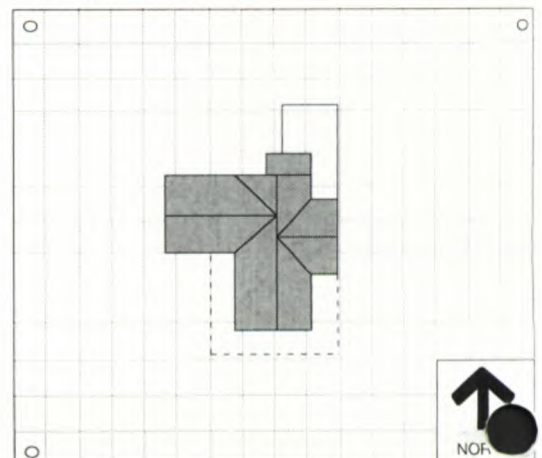

Site Number: U - 13 - 515

Informant/ Bibliography: Sanborn maps; Christensen Property Transfer Notes, Historic Port Royal Fdn., photocopy at Historic Beaufort Foundation