

**BEAUFORT COUNTY
HISTORIC SITES SURVEY - 1997**

INTENSIVE LEVEL BUILDING INVENTORY FORM

Statewide Survey Site Form
State Historic Preservation Office
South Carolina Department of Archives and History
Columbia, SC

Site Number: U- 13 - 518
Access County Site #

USGS Quad: 025 Beaufort
Doc. Level: Intensive Level-Building

Historic name(s): Eichberg House Map Ref.: PR 12 Tax Number: R110 011 000 0054 0000
Common name(s): Witten House City Block Ref.: _____ Island: Port Royal Is.
Address/location: 931 9th St. City/Vicinity of (vic.) Port Royal
Date: 1891 Alteration date: 1980 ca.
Ownership: 1. private 2. city 3. county 4. state 5. federal 6. unknown
Category: 1. building 2. site 3. structure 4. object
Historic use(s): single dwelling Current uses: single dwelling

National Register Status: _____ Date: _____ Listing Name: _____ NRIS # _____

SHPO National Register Evaluation: _____ Name: _____

Consultant Recommendation: Contributes to potential local district Name: Port Royal Historic District

Previous Survey: _____ Reference: _____ Notes: _____
 H.A.B.S. Other _____
 Feiss-Wright (1969) _____
 Historic Resources of the Lowcountry (1979) _____
 Milner Historic District Inventory (1979) _____
 A Guide to Historic Beaufort (1995 ed.) _____

Photograph: _____



Photographs:
 prints
 slides
 negatives

Date: 7/1/97

Recorder: D. Schneider, Historic Beaufort Fdn.

Roll # Neg. View of:
B-08 23 N facade & W elev., fac. SE

Style: Folk: I-house Commercial Form:

Core Shape: rectangular Stories: 2 stories Construction: frame
 Roof: Shape: gable (lateral) Material: composition shingle

Chimney: Type: not visible Material:

Exterior Walls: shiplap

Windows: single Type: double hung Pane 6/6
 Config.:

Doors: single Foundation: brick piers
 transom
 sidelights

Porch Height: Porch Width: Porch Roof Shape:
 Porch Details: Decorative Elements:

Outbuildings: none Interior Features:

Number of Related Resources:

Surroundings: residential Acreage: Quadrangle: Beaufort

Alterations: Alteration date: 1980 ca. Integrity: good Condition: good
 Porch removed (1980 ca.)

Description: Rectangular 2 story frame 3 x 1 bay dwelling w/lateral gable roof; 1 story ell wing to rear-E. Exposed rafter ends at roof. Central entrance at 1st level of facade retains paneled door, transom & sidelights and is flanked by 6/6 double hung sash windows. A small modern entrance stoop is centered on the facade.

Historical Data: The building is shown on the 1905, 1913 and 1924 Sanborn maps with a 2 story front porch.

Christensen Notes refer to the site as "Witten House" and list the following chain of title: Daniel F. Appleton to Mary C. Boone, 1/10/1887; Mary C. Boone to F. A. Heidelman, 7/7/1919 [this information not verified].

According to information provided by Historic Port Royal Foundation, the house was built for A. S. Eichberg in 1891.

Sketch:

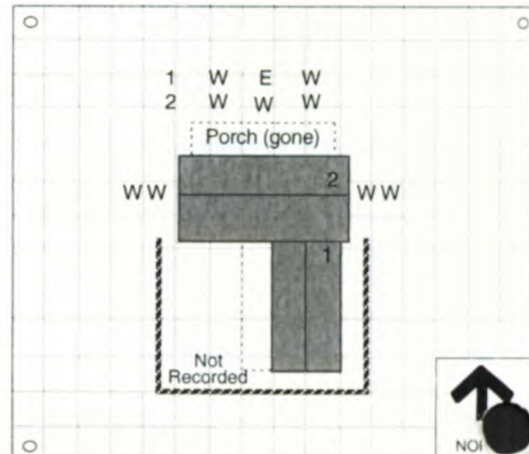

Site Number: U - 13 - 518

Informant/ Bibliography: Sanborn maps; Christensen Property Transfer Notes, Historic Port Royal Fdn., photocopy at Historic Beaufort Foundation