

**BEAUFORT COUNTY
HISTORIC SITES SURVEY - 1997**

INTENSIVE LEVEL BUILDING INVENTORY FORM

Statewide Survey Site Form
State Historic Preservation Office
South Carolina Department of Archives and History
Columbia, SC

Site Number: U- 13 - 536
Access County Site #

USGS Quad: 025 Beaufort
Doc. Level: Intensive Level-Building

Historic name(s): _____ Map Ref.: PR 11 Tax Number: R110 010 000 0091 0000
Common name(s): Kirkland's Boarding House City Block Ref.: _____ Island: Port Royal Is.
Address/location: 1102 11th St. City/Vicinity of (vic.) Port Royal
Date: 1895 ca. Alteration date: 1980 ca.
Ownership: 1. private 2. city 3. county 4. state 5. federal 6. unknown
Category: 1. building 2. site 3. structure 4. object
Historic use(s): single dwelling Current uses: single dwelling

National Register Status: _____ Date: _____ Listing Name: _____ NRIS # _____

SHPO National Register Evaluation: Individually eligible as part of multiple prop. nom. _____ Name: Historic Res. of Port Royal

Consultant Recommendation: Contributes to potential local district Name: Port Royal Historic District

Previous Survey: _____ Reference: _____ Notes: _____
 H.A.B.S. Other _____
 Feiss-Wright (1969) _____
 Historic Resources of the Lowcountry (1979) _____
 Milner Historic District Inventory (1979) _____
 A Guide to Historic Beaufort (1995 ed.) _____

Photograph:



Photographs:

- prints
- slides
- negatives

Date: 7/1/97

Recorder: D. Schneider, Historic Beaufort Fdn.

Roll # Neg. View of:
B-01 18 S facade & W elev., fac. NE

Style: Folk: pyramidal Commercial Form: _____

Core Shape: rectangular Stories: 1 story Construction: frame
 Roof: Shape: hip Material: raised seam metal

Chimney: Type: interior Material: brick

Exterior Walls: weatherboard

Windows: single Type: double hung Pane 2/2
 Config.: _____

Doors: single Foundation: brick piers

Porch Height: 1 story Porch Width: full facade Porch Roof Shape: hip
 Porch Details: turned posts Decorative wood
 other sawn/turned work Elements: _____
 turned balusters

Outbuildings: none Interior Features: _____

Number of Related Resources: _____

Surroundings: residential Acreage: _____ Quadrangle: Beaufort

Alterations: Alteration date: 1980 ca. Integrity: good Condition: good
 Front porch screened, rear porch enclosed, and rear deck added.

Description: Rectangular 5 x 6 bay frame 1-story dwelling w/hipped raised seam metal roof. 1x1 bay rear gable extension at west. Full facade porch w/turned posts & balustrade & sawn brackets; E side has been screened. 1 story porch at rear elevation now enclosed. Facade has central entrance with transom & sidelights flanked by two 2/2 double hung windows. Original entrance door has two arched lights over 2 raised panels. Side elevations have 2/2 windows in each bay.

Historical Data: The house was constructed circa 1895 and served as a boarding house for railroad workers operated by the Kirkland family. Shown on 1924 Sanborn Map. Area not included on 1905 and 1913 Sanborn maps.

Christensen Notes refer to the site as "Kirkland/Edmunds/Hungerford House" and list the following chain of title: Daniel F. Appleton to Port Royal Land Co., 5/1/1891; Port Royal Land Co. to J. A. Fail, 5/9/1894; J. A. Fail to A. H. Burckmeyer, no date; A. H. Burckmeyer to H. W. Kirkland, 6/10/1921 [this information not verified].

Sketch:

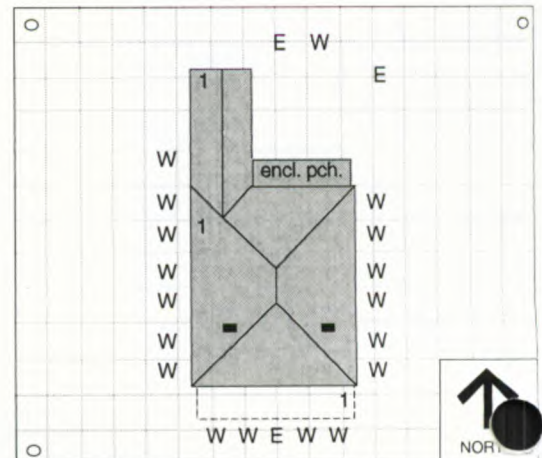

Site Number: U - 13 - 536

Informant/Bibliography: Christensen plat, photocopy at Historic Beaufort Foundation; Sanborn Maps; Christensen Property Transfer Notes, Historic Port Royal Fdn., photocopy at Historic Beaufort Foundation